

YOUR NEST IN BIRD PARADISE



emami*
aāsthā
— JOKA —



Diamond Harbour Road, Joka, Kolkata

emami*
REALTY

Disclaimer: The content published in this brochure is purely conceptual and not a legal offer/advice/representation/inducement. The plans shown in the brochure are indicative only. Nothing other than the amenities and specification enshrined in standard brochure is committed to be provided to the purchaser by Emami Realty Limited unless otherwise specifically mentioned in the agreement for sale. All images are an artistic impression and used for illustrative purposes only. Emami Realty Limited will not be responsible for any omissions or incorrect understanding of any of the terms. Draft for internal circulation only.



9836 29 29 29



sales@modernproperties.in

MODERN
PROPERTIES

Contemporary habitats in a micro forest



Joka, famed for its IIM, now gets another jewel in the crown. Emami Aastha, the 40 acre approx. township nestled in an urban forest. Surrounded by lush greenery, adorned with contemporary amenities this township is made by the best, for the best.

As you drive in through the majestic gates, you reach a wonderland. Greeted by beautiful landscapes bursting with gorgeous blooms, dotted with perfect homes and ample playground for your children to play and grow up in. Four types of premium bungalows, rise on this landscape to fulfill diverse needs of different families. Open gymnasium, air conditioned gym and jogging tracks will turn workouts into a happy, healthy habit. Unleash your inner adventurer as you dine on the floating café or gaze at the stars in the stargazing deck.

Feel the morning dew tenderly touch you as you walk barefeet into the yoga deck or the bougainvillea garden. Sigh in relief as you watch your parents walk in their own senior citizen park without facing any risk of young people knocking them down with bicycles.

Emami Aastha is a place designed to be exactly as you dreamt. A place where you live in faith that only the best will come to you. A place where you will walk in but never want to leave. Come, discover the best gift you can give yourself and your family.

Project Details:

- Premium Bungalow Township
- Aggregating approx 40 acre
- 423 Premium Bungalows
- Nestled in an urban forest, giving a break from the dust and pollution of city life
- Principal designer - Sanjay Puri & Architects



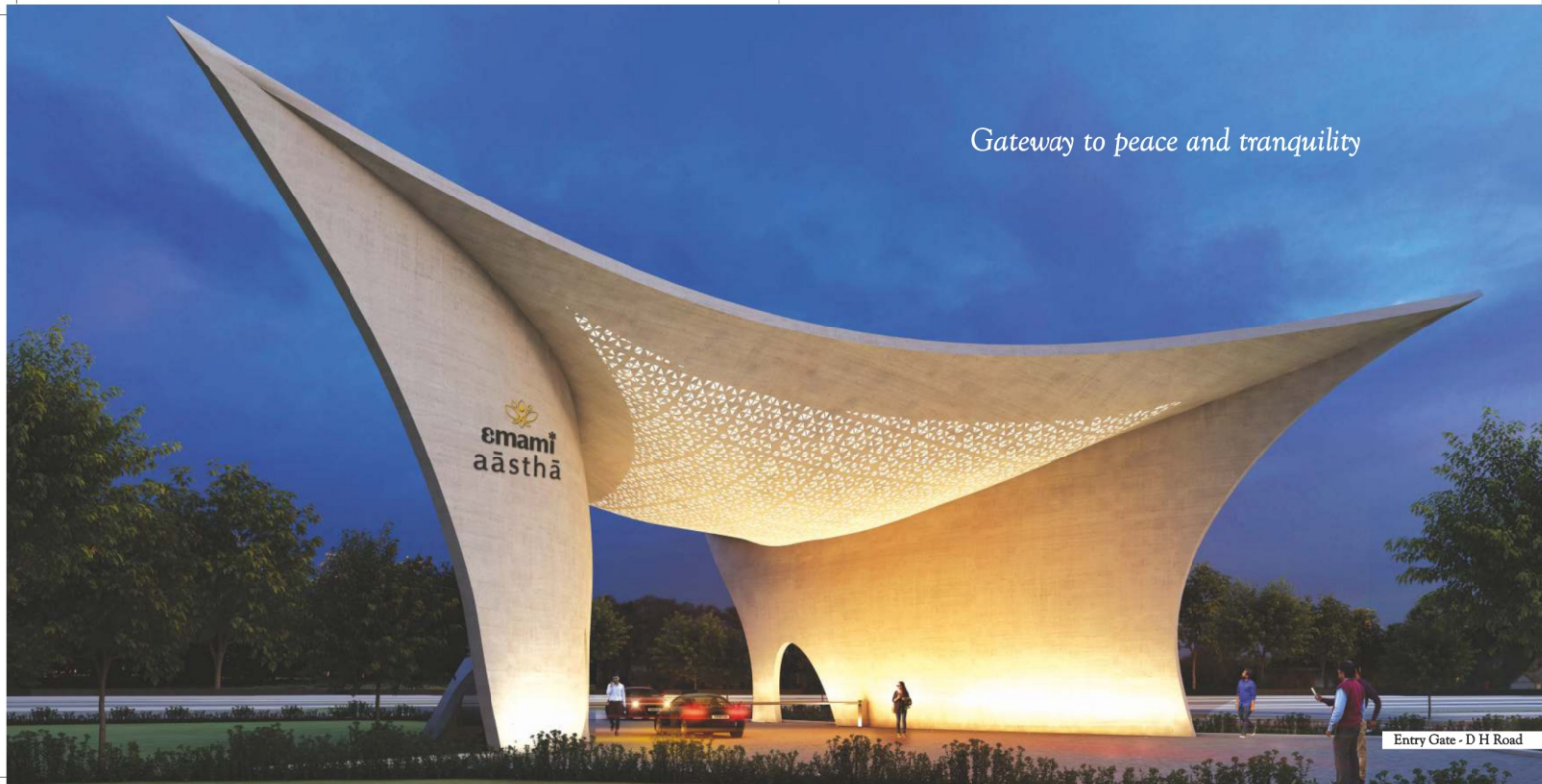

Gateway to peace and tranquility

emami
aāsthā

Entry Gate - D H Road



9836 29 29 29



sales@modernproperties.in

MOD  **RN**
PROPERTIES



*Enter the township
nestled amidst greenery*

Township Entry



9836 29 29 29



sales@modernproperties.in

MOD  **RN**
PROPERTIES



- Thakurpukur Metro - 6 km
- Joka Metro - 4.6 km
- Behala Chowrasta/Metro - 8.8 km
- Taratala Crossing/Metro - 11.2 km
- Tollygunge Metro - 12 km
- Majerhat Railway Station - 12.5 km
- Sealdah Railway Station - 21.2 km
- Howrah Railway Station - 21.5 km



- CMRI Hoospital - 14.4 km
- B M Birla Hospital - 14.5 km
- Thakurpukur Cancer Hospital - 6.8 km
- ESI Hospital - 4.6 km
- Bharat Sevashram Sangha Hospital - 3.2 km



Swami Narayan Temple - 55 m



- Delhi Public School, Joka - 4.5 km
- IIM Calcutta - 4 km
- Vivekananda Mission School - 3.5 km
- Gems Akademia International School - 3.9 km



Zoo - 17.6m



- Alipore/New Alipore - 14.9 km
- Park Street - 19.8 km
- BBD Bag - 20.8
- Salt lake - 30 km
- New Town - 34.3 km



Kolkata International Airport - 38.1 km

Areas are approx. Source: Google Map



9836 29 29 29



sales@modernproperties.in





Floating Cafe



Walking & Jogging Track



Amphitheatre



9836 29 29 29



sales@modernproperties.in

MOD  **RN**
PROPERTIES



Kid's Play Area



Net Cricket Turf



Yoga Deck



9836 29 29 29



sales@modernproperties.in

MOD  **RN**
PROPERTIES



Temple



Lake



Stargazing Deck



- Beautifully designed entry gate on D H Road and Township
- Fully secured with 3 tier security
- Wide internal roads
- Beautifully landscaped main driveway
- Lush green open area with water bodies
- Aroma garden, Bougainvillea garden
- Community garden
- Floating Café with Cycling Track
- Lake with Pedal Boat
- Walking and Jogging Track
- Outdoor Gym area, Yoga Deck
- Life size Chess, Net Cricket Turf
- Amphitheatre, Stargazing Deck
- Rock Climbing, Sandpit
- Senior citizen's seating area, Meditation area
- Kid's and Toddler's play area, Skating Rink
- Fish Feeding area
- Pet relieving area
- Serene Temple
- Reflexology Court
- Daily Needs Shops



9836 29 29 29



sales@modernproperties.in

MODERN
PROPERTIES

An enviable lifestyle awaits you



Club MIE with Swimming Pool



9836 29 29 29



sales@modernproperties.in

MOD  **RN**
PROPERTIES



Club MIE

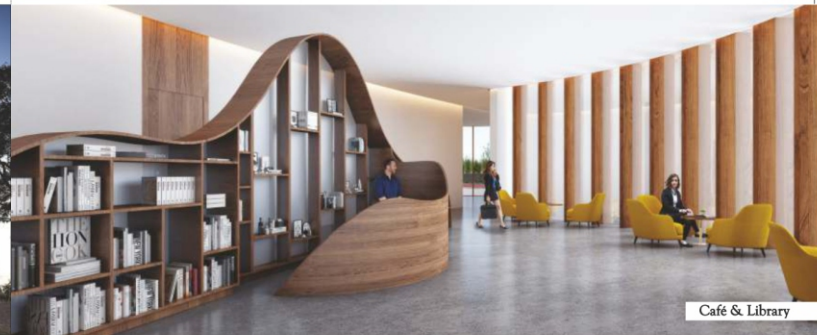

Café & Library

- 18000 sq ft approx. Club House with all modern amenities
- Gymnasium with world class equipments
- Swanky swimming pool
- Banquet Hall, Party Lawns
- Guest Room
- Bar cum Restaurant
- Cafeteria, Library
- Kid's play area
- Indoor games area
- Mini Movie / AV Theatre



Gymnasium



Banquet



Club Lobby



9836 29 29 29



sales@modernproperties.in

MODERN
PROPERTIES

Master Plan

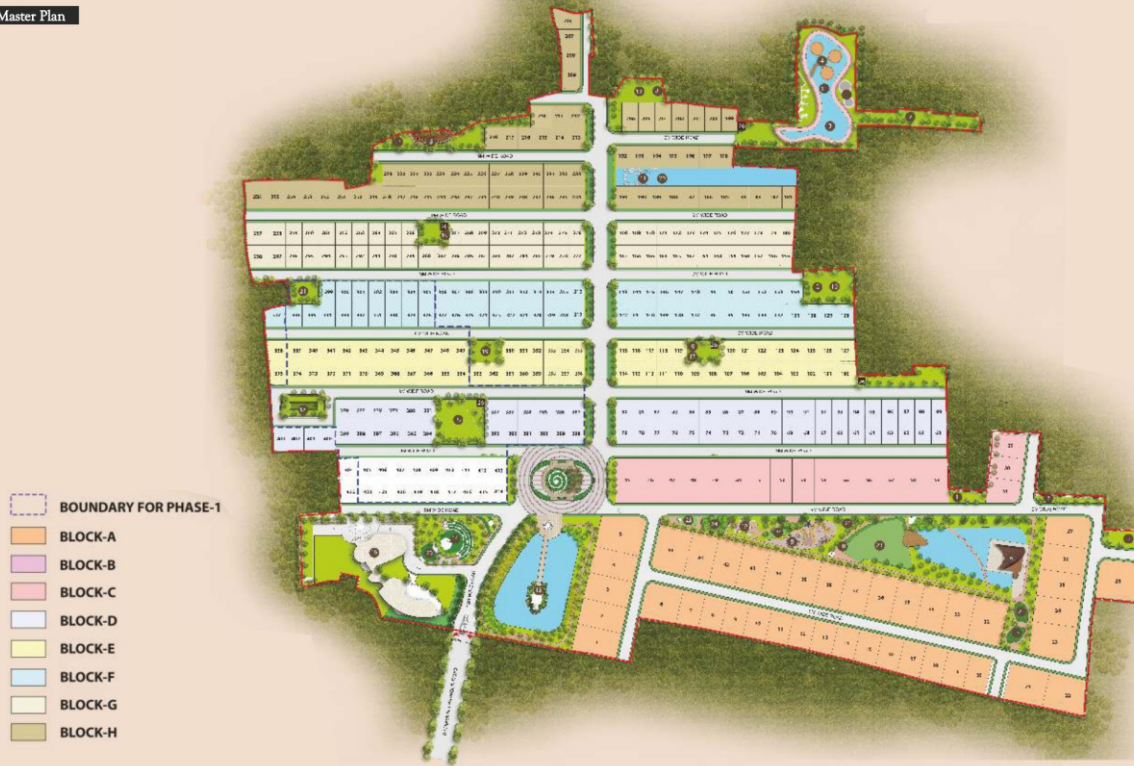

- BOUNDARY FOR PHASE-1
- BLOCK-A
- BLOCK-B
- BLOCK-C
- BLOCK-D
- BLOCK-E
- BLOCK-F
- BLOCK-G
- BLOCK-H

- 1 SKATING RINK
- 2 AROMA GARDEN
- 3 FISH FEEDING AREA
- 4 FLOATING CAFE
- 5 STARGAZING DECK
- 6 YOGA DECK
- 7 PET RELIEF AREA
- 8 SR CITIZEN PARK
- 9 KIDS PLAY AREA
- 10 JOGGING TRACK
- 11 LAKE
- 12 ROCK CLIMBING
- 13 OUTDOOR GYM
- 14 AMPHITHEATER
- 15 TEMPLE
- 16 CLUB
- 17 LIFE SIZE CHESS
- 18 NET CRICKET TURF
- 19 SRCITIZEN GARDEN
- 20 PADDLE BOAT LAKE
- 21 REFLEXOLOGY GARDEN
- 22 CHIP & PUTT GREEN
- 23 LAWN
- 24 MOUNDS
- 25 SCULPTURE COURT
- 26 RETAIL KIOSK



9836 29 29 29



sales@modernproperties.in

MODERN
PROPERTIES

*A Township designed
with you in mind*



Aerial view of the Township



9836 29 29 29



sales@modernproperties.in

MOD  **RN**
PROPERTIES

Phase - 1 : Area Chart

Plot	Block	Facing	Bungalow	Area in Cottah	Area in sq ft
299	E	West	Pratishtha	2.47	2192.18
300	E	West	Pratishtha	2.47	2192.18
301	E	West	Pratishtha	2.47	2192.18
302	E	West	Pratishtha	2.47	2192.18
303	E	West	Pratishtha	2.47	2192.18
304	E	West	Pratishtha	2.47	2192.18
305	E	West	Pratishtha	2.47	2192.18
328	E	East	Pratham	2.47	2076.93
329	E	East	Pratham	2.47	2076.93
330	E	East	Pratham	2.47	2076.93
331	E	East	Pratham	2.47	2076.93
332	E	East	Pratham	2.47	2076.93
333	E	East	Pratham	2.47	2076.93
334	E	East	Pratham	2.47	2076.93
335	E	East	Pratham	2.47	2076.93
336	E	East	Pratham	2.44	2076.93
339	D	West	Pratishtha	2.47	2192.18
340	D	West	Pratishtha	2.47	2192.18
341	D	West	Pratishtha	2.47	2192.18
342	D	West	Pratishtha	2.47	2192.18
343	D	West	Pratishtha	2.47	2192.18
344	D	West	Pratishtha	2.47	2192.18
345	D	West	Pratishtha	2.47	2192.18
346	D	West	Pratishtha	2.47	2192.18
347	D	West	Pratishtha	2.47	2192.18
348	D	West	Pratishtha	2.47	2192.18
349	D	West	Pratishtha	2.47	2192.18
364	D	East	Pratham	2.47	2076.93
365	D	East	Pratham	2.47	2076.93
366	D	East	Pratham	2.47	2076.93
367	D	East	Pratham	2.47	2076.93
368	D	East	Pratham	2.47	2076.93
369	D	East	Pratham	2.47	2076.93
370	D	East	Pratham	2.47	2076.93
371	D	East	Pratham	2.47	2076.93
372	D	East	Pratham	2.47	2076.93
373	D	East	Pratham	2.47	2076.93
374	D	East	Pratham	2.47	2076.93
376	C	West	Pratishtha	2.47	2192.18
377	C	West	Pratishtha	2.47	2192.18

1 sq mtr = 10.7639 sq ft
1 Cottah = 720 sq ft

Phase - 1 : Area Chart

Plot	Block	Facing	Bungalow	Area in Cottah	Area in sq ft
378	C	West	Pratishtha	2.47	2192.18
379	C	West	Pratishtha	2.47	2192.18
380	C	West	Pratishtha	2.47	2192.18
381	C	West	Pratishtha	2.47	2192.18
383	C	West	Pratishtha	2.47	2192.18
384	C	West	Pratishtha	2.47	2192.18
385	C	West	Pratishtha	2.47	2192.18
386	C	West	Pratishtha	2.47	2192.18
387	C	West	Pratishtha	2.47	2192.18
388	C	East	Pratham	2.47	2076.93
389	C	East	Pratham	2.47	2076.93
390	C	East	Pratham	2.47	2076.93
391	C	East	Pratham	2.47	2076.93
392	C	East	Pratham	2.47	2076.93
393	C	East	Pratham	2.47	2076.93
394	C	East	Pratham	2.47	2076.93
395	C	East	Pratham	2.47	2076.93
396	C	East	Pratham	2.47	2076.93
397	C	East	Pratham	2.47	2076.93
398	C	East	Pratham	2.47	2076.93
399	C	East	Pratham	2.47	2076.93
405	B	West	Pratishtha	2.47	2192.18
406	B	West	Pratishtha	2.47	2192.18
407	B	West	Pratishtha	2.47	2192.18
408	B	West	Pratishtha	2.47	2192.18
409	B	West	Pratishtha	2.47	2192.18
410	B	West	Pratishtha	2.47	2192.18
411	B	West	Pratishtha	2.47	2192.18
412	B	West	Pratishtha	2.47	2192.18
413	B	West	Pratishtha	2.47	2192.18
414	B	East	Pratham	2.47	2076.93
415	B	East	Pratham	2.47	2076.93
416	B	East	Pratham	2.47	2076.93
417	B	East	Pratham	2.47	2076.93
418	B	East	Pratham	2.47	2076.93
419	B	East	Pratham	2.47	2076.93
420	B	East	Pratham	2.47	2076.93
421	B	East	Pratham	2.47	2076.93
422	B	East	Pratham	2.47	2076.93

1 Cottah = 720 sq ft 1 sq mtr = 10.7639 sq ft



9836 29 29 29



sales@modernproperties.in





Pratham

Plot Area: 2.01 - 3.40 Cottah
 Total Built Up Area: 1812 - 2077 sq ft
 Total Carpet Area : 1351 - 1590 sq ft
 Balcony Area: 134 - 142 sq ft
 Ground Floor Deck Area: 47 - 102 sq ft

Front & Side Lawn Area: 292 - 386 sq ft
 Backyard Lawn Area: 92 - 144 sq ft
 Private Terrace Area: 489 - 570 sq ft
 Parking Area: 162 - 186 sq ft



Pratishtha

Plot Area: 2.01 - 3.47 Cottah
 Total Built Up Area: 1858 - 2192 sq ft
 Total Carpet Area : 1351 - 1590 sq ft
 Balcony Area: 196 - 259 sq ft
 Ground Floor Deck Area: 47 - 102 sq ft

Front & Side Lawn Area: 296 - 389 sq ft
 Backyard Lawn Area: 92 - 144 sq ft
 Private Terrace Area: 477 - 570 sq ft
 Parking Area: 167 - 188 sq ft



9836 29 29 29



sales@modernproperties.in

MODERN
 PROPERTIES



Prapti

Plot Area: 2.46 - 4.16 Cottah
 Total Built Up Area: 2077 sq ft
 Total Carpet Area : 1590 sq ft
 Balcony Area: 271 sq ft
 Ground Floor Deck Area: 102 sq ft

Front & Side Lawn Area: 389 sq ft
 Backyard Lawn Area: 144 sq ft
 Private Terrace Area: 570 sq ft
 Parking Area: 188 sq ft



Pragati

Bungalow Specifications :

- Large Bedrooms
- Spacious Toilets with walk in wardrobes
- Kid's Room
- Modular Kitchen
- Paved Parking
- Spacious Balcony
- Barbeque Set up
- Plunge Pool (Optional)
- Landscaped front lawns



9836 29 29 29



sales@modernproperties.in

MOD  **RN**
 PROPERTIES

1812 - 1858 sq ft (East Facing)
Ground Floor Plan



1. Deck Area - 15'11" x 4'0"
2. Living Area - 14'5" x 11'0"
3. Kitchen - 7'9" x 10'0"
4. Toilet - 7'9" x 5'0"
5. Bedroom - 10'8" x 13'0"
6. Servant Room - 6'11" x 5'0"
7. Servant Toilet - 6'11" x 3'4"
8. Parking Area - 10'3" x 16'3"
9. Dining Area - 14'5" x 8'10"

Note: The plans shown are only indicative & subject to variations & modifications by the developer & for technical reasons without any notice

1 Sq.M = 10.7639 sq.ft.

First Floor Plan



1. Balcony - 17'2" x 11'5"/15'5" x 6'11"
2. Master Bedroom - 11'0" x 14'9"
3. Dresser - 5'4" x 7'7"
4. Toilet 1 - 5'0" x 7'7"
5. Toilet 2 - 7'9" x 5'0"
6. Bedroom - 10'8" x 13'0"
7. Study Room - 6'11" x 5'0"

Note: The plans shown are only indicative & subject to variations & modifications by the developer & for technical reasons without any notice

1 Sq.M = 10.7639 sq.ft.

1. Pooja Space - 3'0" x 3'3"



9836 29 29 29



sales@modernproperties.in

MODERN
PROPERTIES

1881 - 1894 sq ft (West Facing)
Ground Floor Plan



1. Deck Area - 16'0" x 2'11"
2. Living Area - 14'5" x 11'0"
3. Kitchen - 7'5" x 10'5"
4. Servant Room - 5'0" x 7'0"
5. Servant Toilet - 3'6" x 7'0"
6. Toilet - 8'0" x 5'0"
7. Bedroom - 11'0" x 12'4"
8. Parking Area - 10'3" x 17'3"
9. Dining Area - 14'5" x 8'10"

Note: The plans shown are only indicative & subject to variations & modifications by the developer & for technical reasons without any notice

1 Sq. M = 10.7639 sq. ft.

First Floor Plan



1. Balcony - 15'2"x10'9"/17'2"x13'9"
2. Master Bedroom - 11'0" x 13'9"
3. Dresser - 5'4" x 7'7"
4. Toilet 1- 5'0" x 7'7"
5. Toilet 2 - 10'5" x 5'0"
6. Bedroom - 11'0" x 13'0"
7. Study Room - 6'11" x 4'5"

Note: The plans shown are only indicative & subject to variations & modifications by the developer & for technical reasons without any notice

1 Sq. M = 10.7639 sq. ft.



9836 29 29 29



sales@modernproperties.in

MODERN
PROPERTIES

2077 - 2198 sq ft (East Facing)
Ground Floor Plan



1. Parking Area - 10'11" x 17'6"
2. Deck Area - 20'8" x 4'11"
3. Living Area/Dining Area - 15'7" x 20'5"
4. Kitchen - 10'11" x 9'0"
5. Toilet - 4'3" x 6'8"
6. Bedroom - 11'0" x 12'0"
7. Servant Room - 11'0" x 5'6"
8. Servant Toilet - 6'3" x 3'11"

Note: The plans shown are only indicative & subject to variations & modifications by the developer & for technical reasons without any notice

1 Sq M = 10.7639 sq ft

First Floor Plan



1. Balcony - 21'3"x11'11"/20'7"x6'10"/21'11"x11'10"
2. Master Bedroom - 11'0" x 13'6"
3. Dresser - 10'11" x 5'4"
4. Toilet 1 - 10'11" x 6'4"
5. Toilet 2 - 4'3" x 8'0"
6. Bedroom - 11'0" x 12'0"
7. Kid's Bedroom - 11'0" x 6'10"

Note: The plans shown are only indicative & subject to variations & modifications by the developer & for technical reasons without any notice

1 Sq M = 10.7639 sq ft



1. Pooja Space - 4'3" x 2'0"



9836 29 29 29



sales@modernproperties.in

MODERN
PROPERTIES

2077 - 2197 sq ft (West Facing)
Ground Floor Plan



1. Deck Area - 20'8" x 4'11"
2. Living Area/Dining Area - 15'7" x 20'5"
3. Kitchen - 10'11" x 9'0"
4. Toilet - 4'3" x 6'8"
5. Servant Toilet - 3'5" x 4'3"
6. Servant Room - 7'2" x 4'3"
7. Bedroom - 11'0" x 12'0"
8. Crockery Unit - 11'0" x 5'7"
9. Parking Area - 10'11" x 17'2"

Note: The plans shown are only indicative & subject to variations & modifications by the developer & for technical reasons without any notice

1 Sq.M = 10.7639 sq.ft

First Floor Plan



1. Balcony 21'3"x11'11"/20'7"x6'10"/21'11"x11'10"
2. Master Bedroom - 11'0" x 13'6"
3. Dresser - 10'11" x 5'4"
4. Toilet 1- 10'11" x 6'4"
5. Toiler 2 - 4'3" x 8'0"
6. Bedroom - 11'0" x 12'0"
7. Kid's Bedroom - 11'0" x 6'10"

Note: The plans shown are only indicative & subject to variations & modifications by the developer & for technical reasons without any notice

1 Sq.M = 10.7639 sq.ft



9836 29 29 29



sales@modernproperties.in

MODERN
PROPERTIES

Infrastructure Specifications

- State of the art maintenance
- Smart Home App
- Gated Boundary Wall
- Wide Internal Roads with Footpaths
- Street Lighting
- Electrical Substation with HT and LT distribution system
- Sewer and Storm water drainage system
- Water supply network with underground tanks
- STP and solid waste management
- Garbage disposal management
- Garden irrigation system
- Rain water harvesting system

General Features

- Smart Home App
- Video Door Phone on Main Door
- Paved Parking
- Anti-Termite Treatment
- Waterproofing on terrace

Bungalow Specifications

Structure:

Earthquake resistant RCC framed structure

Flooring:

Master Bedrooms - Wooden Flooring
Other Bedroom/ Living / Dining - Vitrified tiles

Kitchen:

Flooring - Vitrified tiles;
Dado & Walls - Combination of Paint & Ceramic Tiles
Counter Top - Granite
Sink - Stainless steel with drain board
Modular kitchen with Cabinets

Doors:

Painted hard wood frames with painted flush door
Windows : UPVC/Powder coated aluminium windows

Toilets:

Flooring - Antiskid ceramic tiles
Walls/Dado - Tile upto 7ft
Fittings & fixtures:
Sanitary ware - Jaguar / Hindware/equivalent
Branded CP fittings

Electrical:

Provision for AC units in all bedrooms, living and dining room
TV Points in all bedrooms & Living /Dining Room
Modular switches
3 phase concealed copper wirings
MCB distribution box
Provision for washing machine point

Power Back Up:

1812 sq ft - 2.26 KVA
1894 sq ft - 2.37 KVA
2015 sq ft - 2.52 KVA
2077 sq ft - 2.60 KVA
2192 sq ft - 2.74 KVA
2197 sq ft - 2.75 KVA
(@1 W / 0.00125 KVA per sq ft - at an additional cost)

Wall Finish:

Internal Walls - POP Finish;
External Walls - Weather Proof paint

Super Features

- Pool with Deck - Optional Plunge Pool on terrace top at additional cost
- Landscape - Landscape front lawn
- Terrace Top Feature - Barbeque set up with seating area, Landscaped terrace
- Pooja Room - Marble bedi top in puja room



9836 29 29 29



sales@modernproperties.in

MODERN
PROPERTIES